

### System Lockdown Software for Mission-Critical Devices

Organizations today such as factories, health care, and utility companies are facing a growing number of cyber threats to their industrial control systems (ICS), Industrial IoT devices, and embedded devices used in daily operations. Systems that rely on components using older operating systems are especially vulnerable, as they are likely not up-to-date on security patches and contain vulnerabilities attackers can exploit.

Taking advantage of “Lockdown” by controlling system resources, access and limiting execution of applications only to those that are necessary for daily operations, could extremely prevents the intrusion and execution of malware without relying on the pattern files of attacking resources.

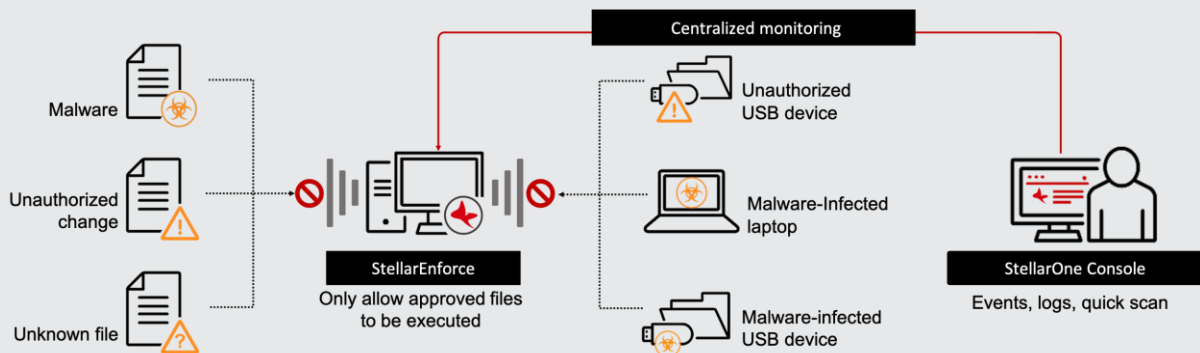

### Benefits

#### Lockdown 4 in 1

- Operation Lockdown, USB Device Lockdown, Data Lockdown and Configuration Lockdown secure operational integrity while efficiently reducing the chance of downtime and cost of resilience
- Flexibility to fit into your daily operations

#### Minimal Performance Impact

- The core framework of TXOne StellarEnforce™ protects systems by allowing only pre-registered applications and services to execute, results in a negligible impact on system performance compared to traditional cybersecurity software which requires an Internet connection, periodic updates, and regular malware scans

#### Security Solution for Industrial Environment

- TXOne StellarEnforce is specifically designed for critical industrial environment, and optimizes the operational efficiency for mass deployment and maintenance in large factory, while reducing the chance of downtime and operational cost

#### Easy Deployment and Maintenance

- All files that are allowed to execute on the terminal are automatically collected and registered to the approved list after installation
- Approved list will also be auto-updated for runtime operations during maintenance to minimize downtime for patching or maintenance

#### Protect legacy operating system

- Specially support the EOS windows such as Windows XP/2000

#### Secure Mission-Critical Devices

- Supervisory Control and Data Acquisition (SCADA)
- Human Machine Interface (HMI)
- Engineering Workstations (EWS)
- PC-based controller
- Database server
- Fixed-function devices
- Industrial IoT devices



# Key Features

## Agent

- Application whitelisting
- USB device whitelisting
- Maintenance mode
- Write protection
- Integrity monitoring
- File-less attack prevention
- Exploit protection
- Approved list management
- Pre-scan (malware inspection during install)
- Role based administration

- Support endpoint scheduled and on-demand AV scan (StellarEnforce AV Edition)
- Log aggregation
- Intelligent runtime learning

## Management Console (StellarOne™)

- Centralized monitoring
- Notification
- Account management
- Syslog forwarding
- Trusted certificates management
- Support IOC integration
- Integrate MITRE ICS IDs in event logs
- Scan exclusions management

## TXOne StellarEnforce™ System Requirements

TXOne StellarEnforce™ Agent		
	Client OS	Server OS
<b>OS</b>	Windows 2000 (SP4) [Professional] (32bit) Windows XP (SP1/SP2/SP3) [Professional] (32bit) Windows Vista (No SP/SP1/SP2) [Business / Enterprise / Ultimate] (32bit) Windows 7 (No SP/SP1) [Professional / Enterprise / Ultimate] (32/64bit) Windows 8 (No SP) [Pro/Enterprise] (32/64bit) Windows 8.1 (No SP) [Pro/Enterprise/with Bing] (32/64bit) Windows 10 (RS1/RS2/RS3/RS4/RS5) [Pro/Enterprise/IoT Enterprise] (32/64bit) Windows XP Embedded (SP1/SP2) (32bit) Windows Embedded Standard 2009 (No SP) (32bit) Windows Embedded Standard 7 (No SP/SP1) (32/64bit) Windows Embedded 8 Standard (No SP) (32/64bit) Windows Embedded 8.1 [Pro/Industry Pro](No SP) (32/64bit) Windows XP Professional for Embedded Systems (SP1/SP2/SP3) (32bit) Windows Vista for Embedded Systems (No SP/SP1/SP2) (32bit) Windows 7 for Embedded Systems (No SP/SP1) (32/64bit) Windows Embedded POSReady (32bit) Windows Embedded POSReady 2009 (32bit) Windows Embedded POSReady 7 (32/64bit)	Windows 2000 Server (SP4) (32bit) Windows Server 2003 (SP1/SP2) [Standard / Enterprise / Storage] (32bit) Windows Server 2003 R2 (No SP/SP2) [Standard / Enterprise / Storage] (32bit) Windows Server 2008 (SP1/SP2) [Standard / Enterprise / Storage] (32/64bit) Windows Server 2008 R2 (No SP/SP1) [Standard / Enterprise / Storage] (64bit) Windows Server 2012 (No SP) [Essentials/Standard] (64bit) Windows Server 2012 R2 (No SP) [Essentials/Standard] (64bit) Windows Server 2003 for Embedded Systems (SP1/SP2) (32bit) Windows Server 2003 R2 for Embedded Systems (No SP/SP2) (32bit) Windows Server 2008 for Embedded Systems (SP1/SP2) (32/64bit) Windows Server 2008 R2 for Embedded Systems (No SP/SP1) (64bit) Windows Server 2012 for Embedded Systems (No SP) (64bit) Windows Server 2012 R2 for Embedded Systems (No SP) (64bit) Windows Server 2016 (No SP) [Standard] (64bit) Windows Storage Server 2016 (64bit)
<b>CPU</b>	Conforms with minimum OS system requirements	
<b>Memory</b>	Conforms with minimum OS system requirements	
<b>Free Disk Space</b>	300 MB or more	
<b>Display Resolution</b>	VGA (640x480) or more, 16 colors or more	
TXOne StellarOne™ Virtual Appliance		
<b>Supported Hypervisors</b>	VMWare ESX 6.X or above	
<b>Browser</b>	Microsoft Internet Explorer 11.0 Google Chrome 87 or latest Microsoft Edge 79 or latest Mozilla Firefox 78 or latest	

